

Notes: -
 For marine applications, use
 a silicone sealant or a
 bedding compound to avoid
 electrolytic action between
 the cleat and metal
 fastenings.

Section 'AA'

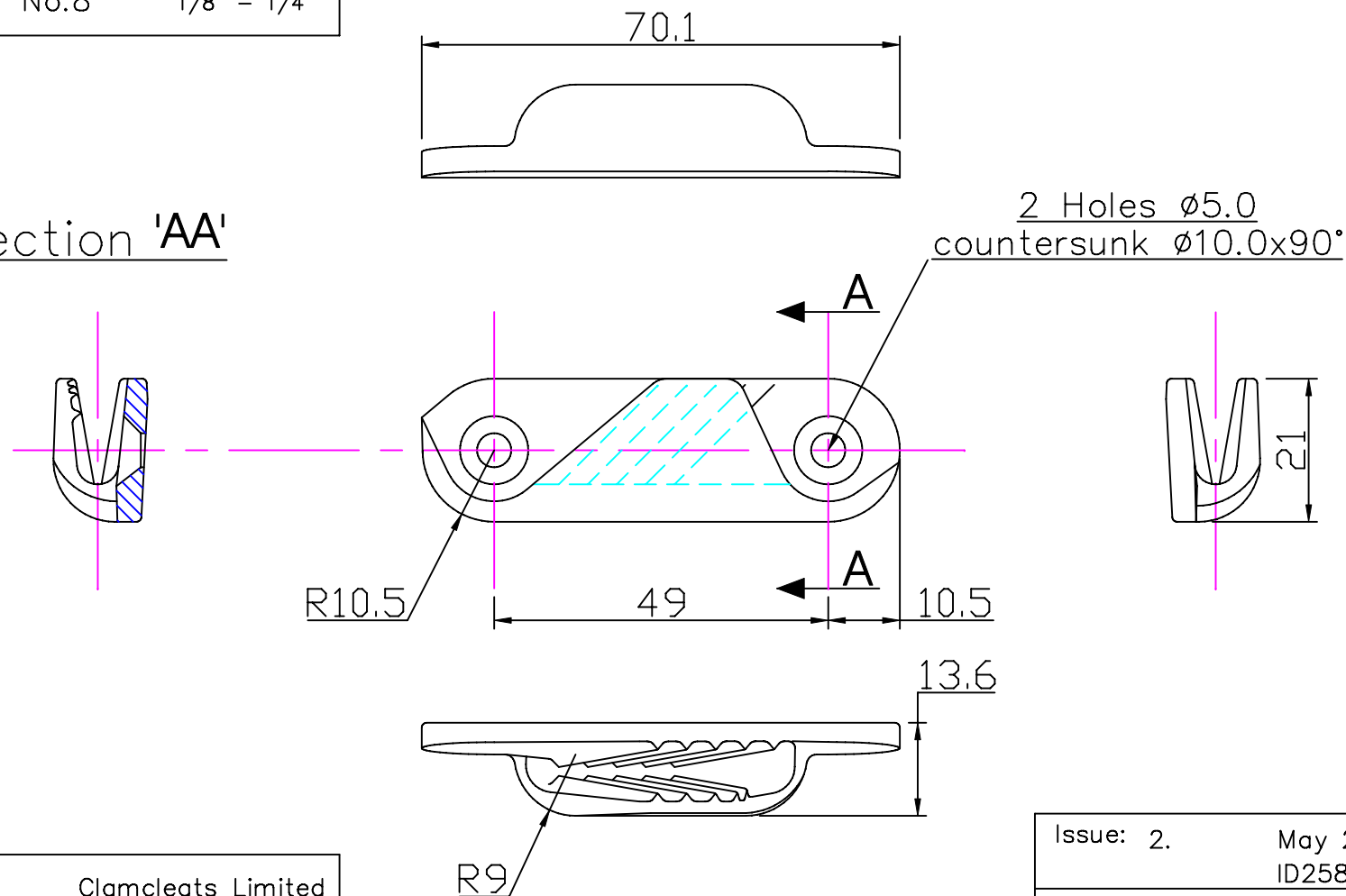

Issue: 2. May 2006
 ID258.dwg

Material:
 Diecast Aluminium

Installation Drawing for:-
CL258
 Racing Fine Line
 (Starboard)



Clamcleats Limited
 Watchmead
 Welwyn Garden City
 Hertfordshire AL7 1AP
 England

Telephone +44 (0)1707 330101
 Fax +44 (0)1707 321269
<http://www.clamcleat-rope-cleats.com>



Scale 1:1
 All dimensions in mm.